

# Ampatex® Variano 3 extra

Moisture-variable vapour check and airtight layer, lattice-reinforced



- > Ideal for injection insulation due to its high tear resistance
- > Over 59 m s<sub>D</sub> value range for maximum protection in buildings where moisture levels are critical
- > Excellent adhesive properties
- > Hydrosafe and saddle-point protective effects for building carcasses in wintertime

Technical details		Value	Standard
s <sub>D</sub> value		0.80m–60m	EN 1931
Weight		110g/m <sup>2</sup> (±5%)	EN 1849-2
Tear-proof qualities	lengthwise	300N/5cm	EN 12311-2/A
	cross	250N/5cm	
Elongation at break	lengthwise	20%	EN 12311-2/A
	cross	20%	
Resistance to further tearing (nail shank)	lengthwise	200N	EN 12310-1
	cross	220N	
Fire behaviour		E	EN 13501-1
Watertight at 2 kPa		standard met	EN 1928
Width of overlap		10 cm	
Straightness		< 75 mm/10 m	EN 1848-2
Temperature resistance		–40 bis +80 °C	
Hydrosafe value of		2,45 m	DIN 68 800-2
Remains durable after artificial ageing		standard met	EN 1296
Shear resistance of joint seams		130 N	EN 12317-2

**Area of application:** Perfectly suited for flat roofs in timber construction; also for renovating pitched roofs with a dense outer skin. The tape offers special protection when used on bare brickwork in winter. Ideal for injection insulation due to its high tear resistance.



\*Conditions for the twenty-year premium warranty include registering the building object and the Ampack products used. In addition, our products must be used as part of a system. For further details, please see our General Warranty Conditions.

Delivery forms			
Item no.	Identification	Roll dimensions	Pallet contents
7640442090578	Ampatex® Variano 3 extra with 60 m Ampacoll® INT	1,5 m × 50 m = 75 m <sup>2</sup>	40 rolls = 3000 m <sup>2</sup>
7640442090431	Ampatex® Variano 3 extra	1,5 m × 50 m = 75 m <sup>2</sup>	40 rolls = 3000 m <sup>2</sup>

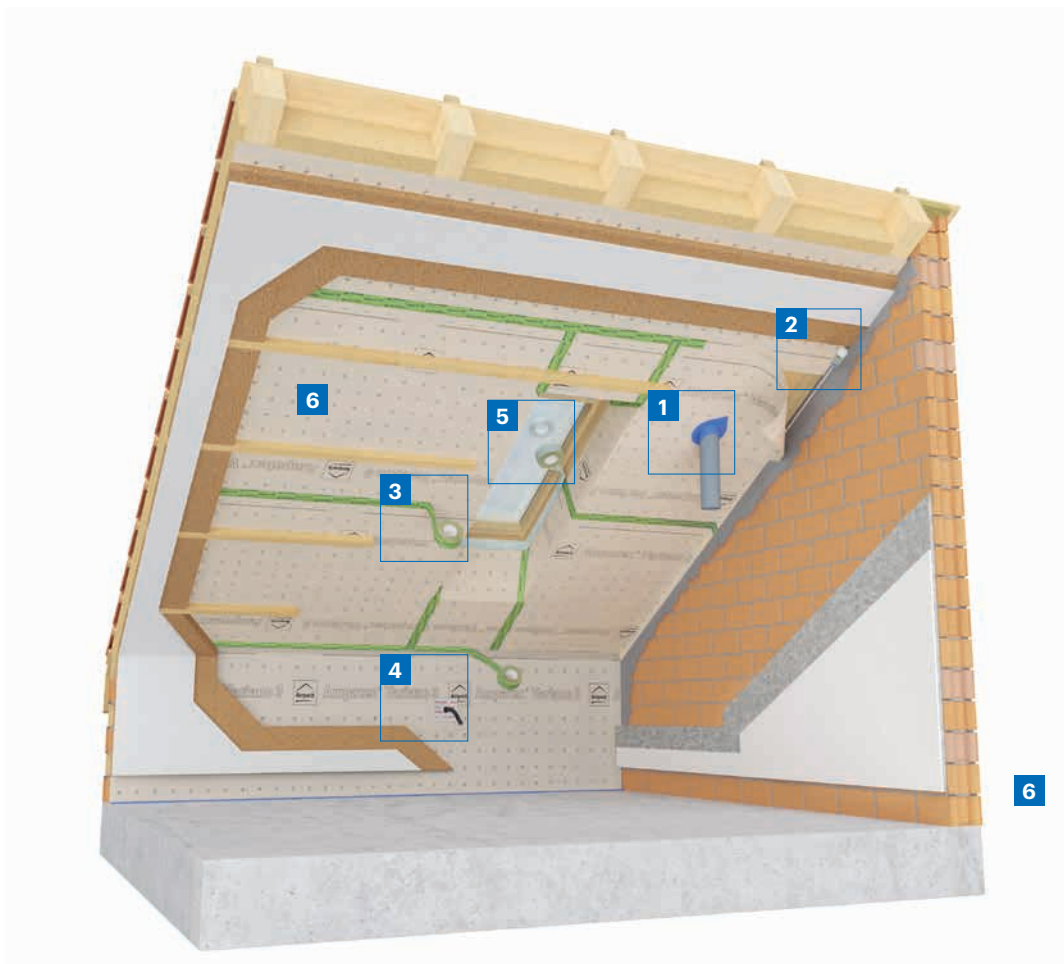

**6 Ampatex® Variano 3 extra**  
Moisture-variable vapour check and airtight layer, lattice-reinforced



## Application tips

**Ampatex® Variano 3 extra** is applied as an airtight layer and moisture-variable vapour check for dry interior finishing and positioned on the warm side of the thermal insulation where it is stapled to the construction. Take care when positioning it that the membranes overlap by 10 cm and that the joints are tightly sealed with the enclosed system adhesive strip **Ampacoll® INT**. Edge connections must be sealed with **Ampacoll® BK 530** or **Ampacoll® RA**.

Porous or dusty surfaces must be pretreated with **Ampacoll® Primax**. Penetrations such as ventilation and electric pipes must be permanently sealed with **Ampacoll® BK 535** or **Ampacoll® Elektro u. Install** sleeves. Humidity-variable materials can react to strong changes in ambient humidity. Consider shrinkage and expansion behaviour (e.g. conditioning on site, relief loops, mechanical securing, etc.).

 Please observe the recommendations for use and further system products in our adhesives matrix

 Further information and detailed documentation at [www.ampack.biz](http://www.ampack.biz)

Sales via specialist dealers

Ampack Switzerland: +41 71 858 38 00  
Ampack Austria: +43 5523 53433  
Ampack Germany: +49 7621 1610264  
Ampack France: +33 4 50 83 70 54  
Ampack Italy: +39 471 053 475

[www.ampack.biz](http://www.ampack.biz)



The following information may have been superseded by new findings or developments. Current Information can be found at [www.ampack.biz](http://www.ampack.biz). © Ampack AG, Rorschach, 03.2022

4131EU/EXX.YYFO(VS)0322